

Floor to Ceiling Glass Shelving Kits

Installation FFCSGS Shelving Kit

fig 1

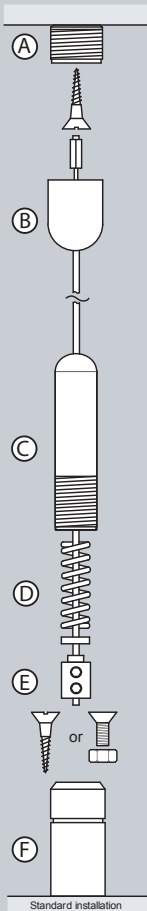

- 1) Fix fitting A to ceiling.
- 2) Screw fitting B to fitting A.
- 3) Using a plumb-line, plumb down from A and fix F to floor using appropriate type of fixing.
- 4) Loosen the grub screws in fitting E, using allen key provided and slide fittings C, D and E up the cable.
- 5) Pull down the cable and cut off in line with the decorative line around fitting F.
- 6) Re-tighten E on the end of the cable.
- 7) Adjust the tension of the cable by screwing C into F.

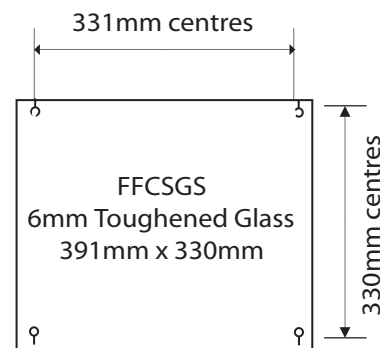

- 1) Mark the four cable positions on floor area using cable centre dimensions above.
- 2) With the use of a plumbline mark the four cable positions on the ceiling.
- 3) Install all four cables (see installation guide fig 1)
- 4) Fix 4 x shelf supports per shelf to the cables in desired position and lower the shelf in to position ensuring that the support locates correctly in the keyhole slot (fig2)
- 5) Adjust shelf to horizontal preferably with a spirit level and repeat procedure for remaining shelves (fig 3)

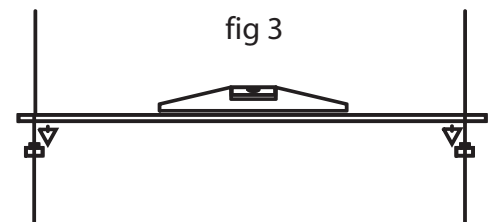
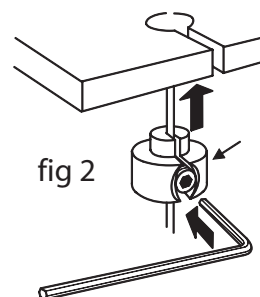

web : www.ral-display.co.uk e-mail : sales@ral-display.co.uk

tel : (0116) 2554640 fax : (0116) 2550572

R.A.L Display Marketing Ltd, 2 Cranmer Street, Leicester LE3 0QA