

POP-UP: ASSEMBLY INSTRUCTIONS

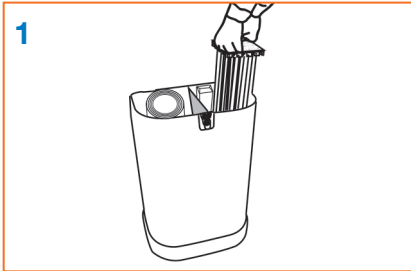

1 A typical kit may consist of: mag bars, d-end graphics x 2 and front and/ or rear graphics.

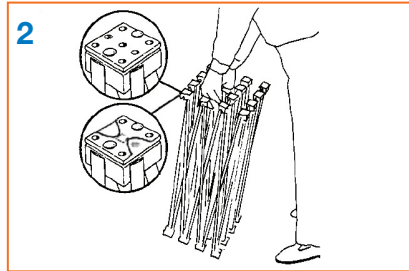

2 Assemble frame with coloured hookstuds at the top.

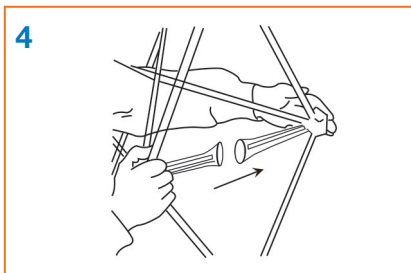
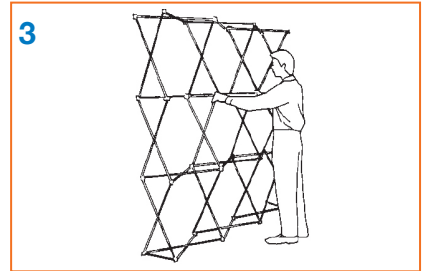

4 Push the locking bars together until they attach magnetically.

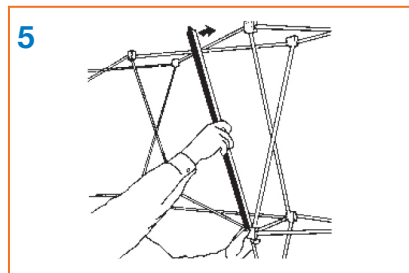

5 Attach magnetic bars to frame.

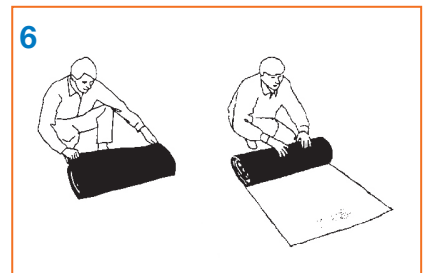

6 Unroll the graphic panels which are labeled on the rear.

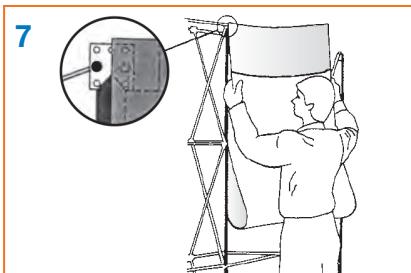

7 Hook on reverse of panel locates on the coloured stud.

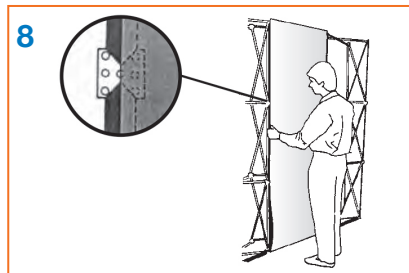

8 Align panel edges down centre of magnetic bar.

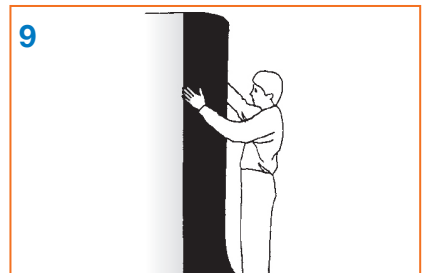

9 End panels curve from front to back.

