

BROCHURE STANDS

ASSEMBLY INSTRUCTIONS

A lightweight polymer based literature holder with 4 pockets. Collapsible for easy transportation and supplied with carry bag.



CAUTION:
Ensure fingers are kept clear of folding mechanism when opening and closing.

hardware specifications

Assembled Dimensions (mm)
1480 (h) x 265 (w) x 310 (d) approx.
58.3" (h) x 10.4" (w) x 12.2" (d) approx.

Closed Dimensions (mm):
360 (h) x 265 (w) x 310 (d) approx.
14.2" (h) x 10.4" (w) x 12.2" (d) approx.

Internal Tray Dimensions (mm):
330 (h) x 224 (w) x 35 (d) approx.
13.0" (h) x 8.8" (w) x 1.4" (d) approx.

Weight: 5.5kg approx (12lbs) including carry bag

features & benefits

- Lightweight, polymer construction
- Versatile one step cantilever assembly action
- 4 pocket capacity
- Robust, transparent polycarbonate literature pockets
- Available in grey
- Carry bag included

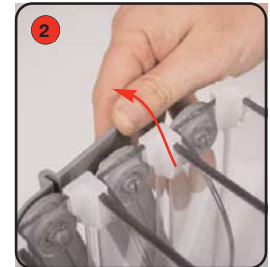

Remove the folded unit from the carry bag and lift the catch on both sides to loosen the pockets.

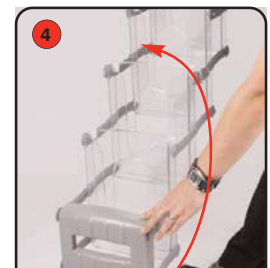

Lift the pockets from the back in an upwards and forwards motion.



Stabilise the literature holder during assembly by placing foot on base.

Secure into assembled position by locating the catches on both sides of the holder.

Tel: 0116 2554640 Fax: 0116 2550572