

# BUDGET COUNTER UNIT

## ASSEMBLY INSTRUCTIONS



### Features & Benefits :

- Lightweight plastic, flat pack promotional server counter
- Extremely cost effective
- Includes rigid header panel, shelf and twin supporting poles
- Supplied with carry bag
- Optional graphic panels

A popular server counter that is lightweight, portable and simple to assemble. Customise your counter with removable Velcro backed flexigraphics or apply permanent vinyl / screen printed graphics. Call 0116 2554640 to discuss your requirements.

### Hardware Specifications

#### Dimensions (mm)

2045 (h) x 810 (w) x 470 (d) approx.

#### Base Dimensions (mm)

850 (h) x 810 (w) x 470 (d) approx.

#### Weight

11.4kg approx (inc carry bag)

### Graphic Dimensions (Optional)

#### Header dimensions:

280 (h) x 770mm (w)

#### Front graphic dimensions:

770 (h) x 820mm (w)

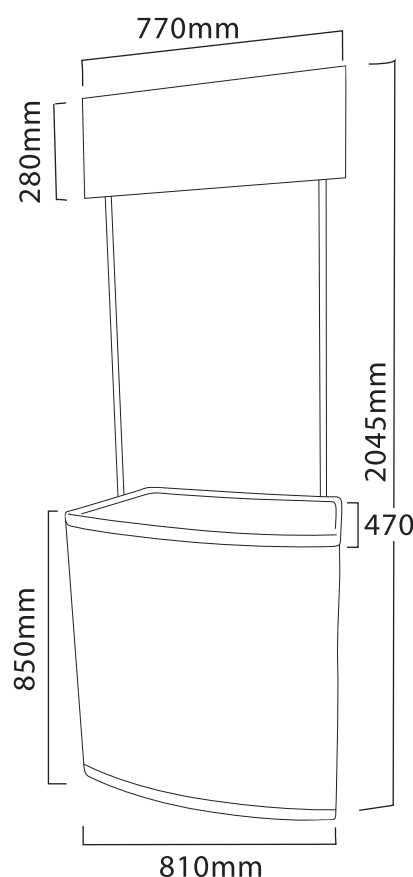

**unit dimensions  
(all approx)**

**Tel: 0116 2554640 Fax: 0116 2550572**

# BUDGET COUNTER UNIT

## ASSEMBLY INSTRUCTIONS

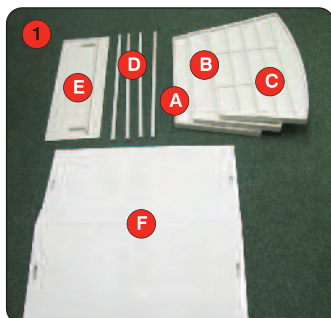

Kit includes: 1 x top (A), 1 x base (B), 1 x internal shelf (C), 4 x poles (D), 1 x header (E), 1 x wrap (F)



Take one of the two identical moulded top/base (A/B) units and place on floor raw edge facing upwards.



Unfold wrap (F) and slot into the base with opening on the shorter edge of the base.

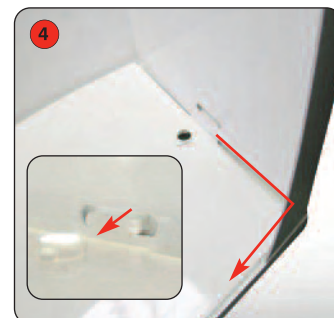

Slot the wrap securely into the base ensuring the pips on either side of the base push through the hole in either side of the wrap.



Take the shelf (C) and slide down through the top of the wrap.

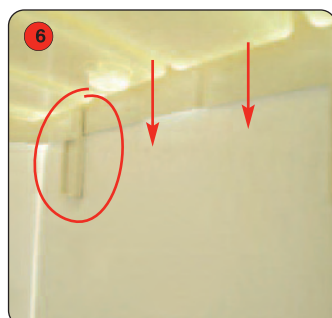

The shelf should slot in tightly into the grooves on the inside of the wrap.

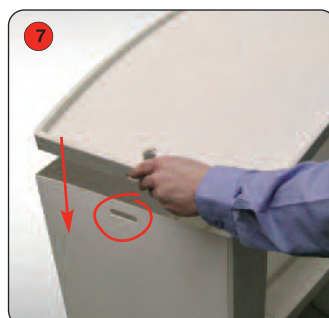

Take the 2nd moulded top/base (A/B) and slot over wrap, again ensuring pips push through wrap

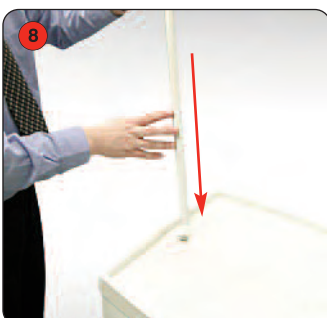

Slot one male pole (D) through the hole in top of unit, ensuring male end is to the outside.



Create header assembly by slotting two poles into the header.  
(male ends into header)



Finally attach the the header assembly to the main unit.



**Tel: 0116 2554640 Fax: 0116 2550572**