

Twist®

TWIST EASI-LINK

product set up instructions

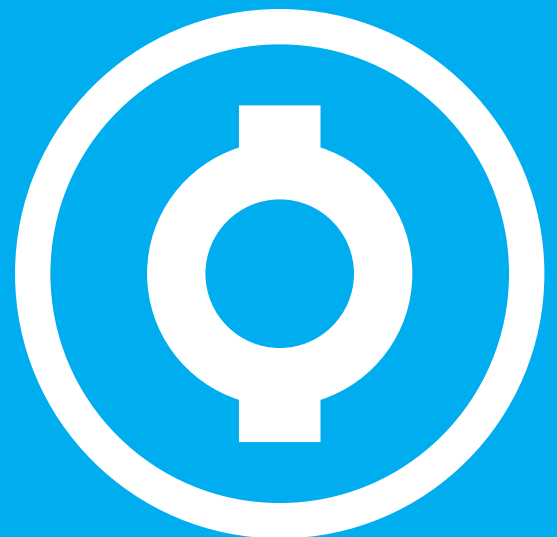

Twist Original Setup Instructions

Items

1x base with rubber grommet; 1x bottom upright section; 1x middle upright section; 1x top upright section; 1x light; 1x transformer; 1x graphic panel with finishing strips.

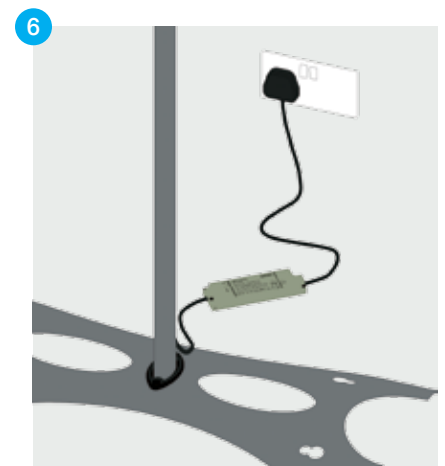
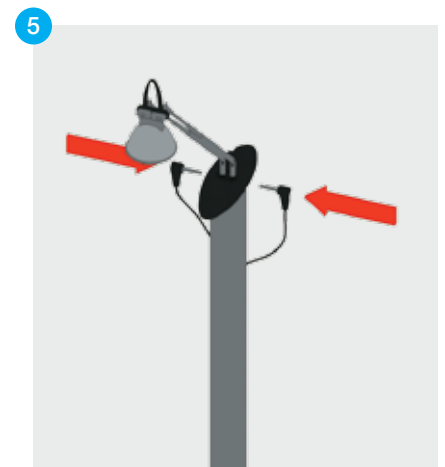
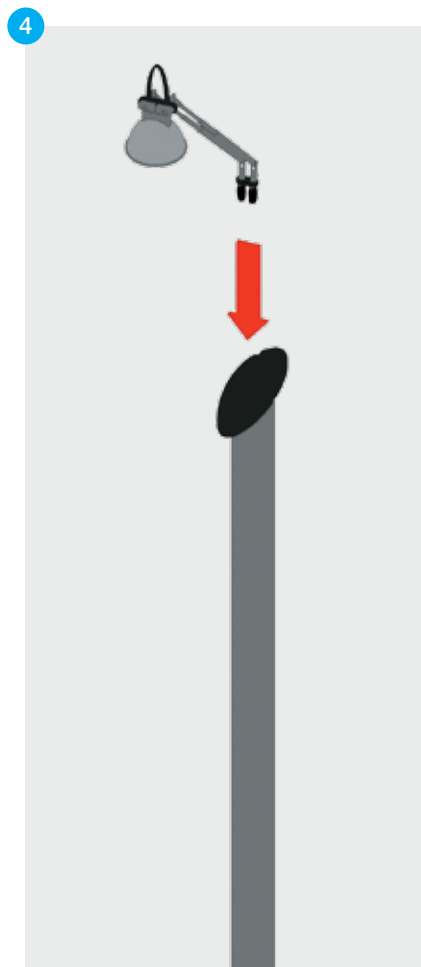
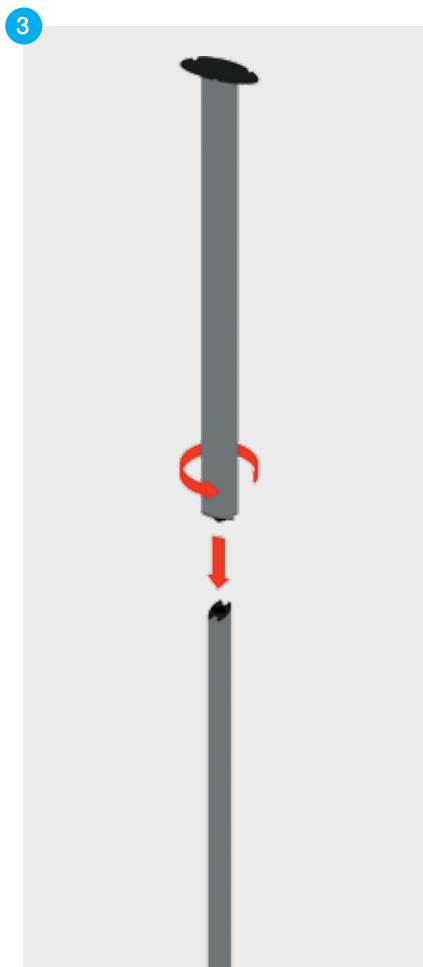
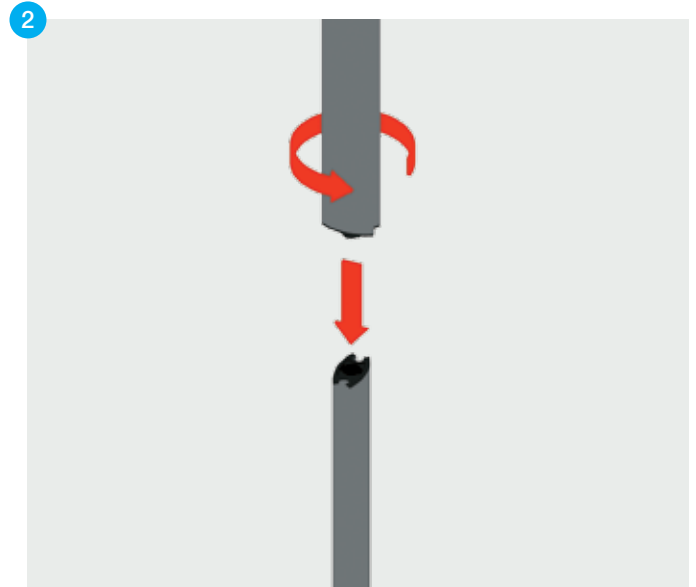
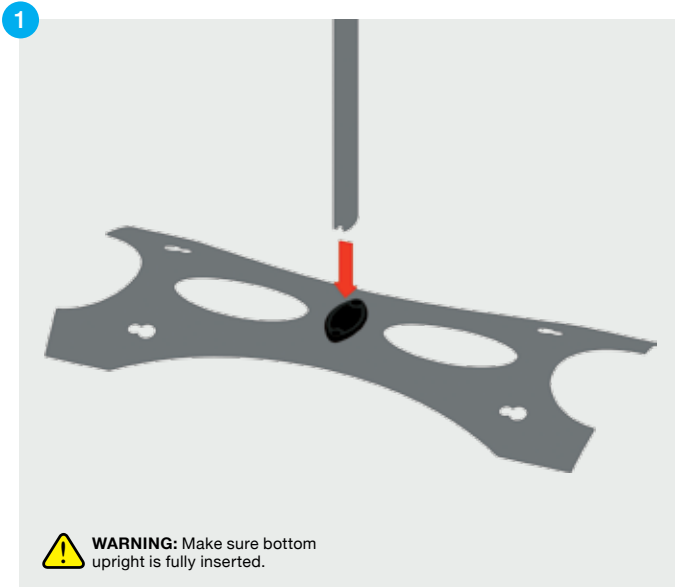

WARNING: Make sure bottom upright is fully inserted. Twist the upright sections clockwise to lock, anti-clockwise to open – do not force.

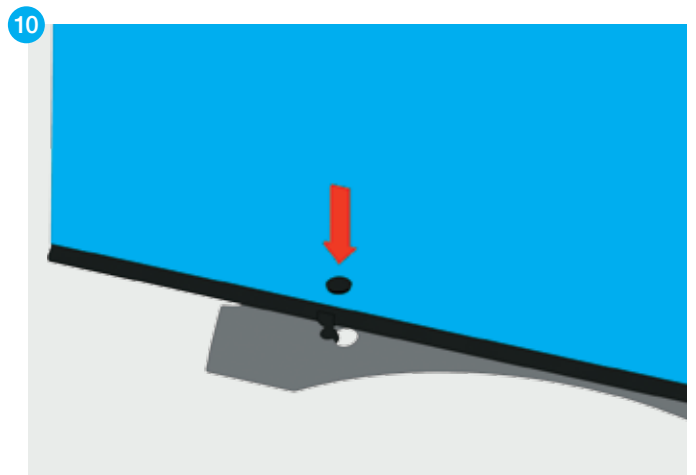
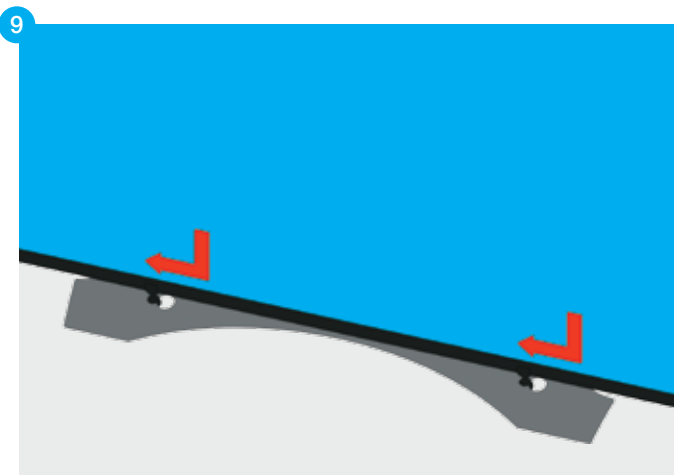
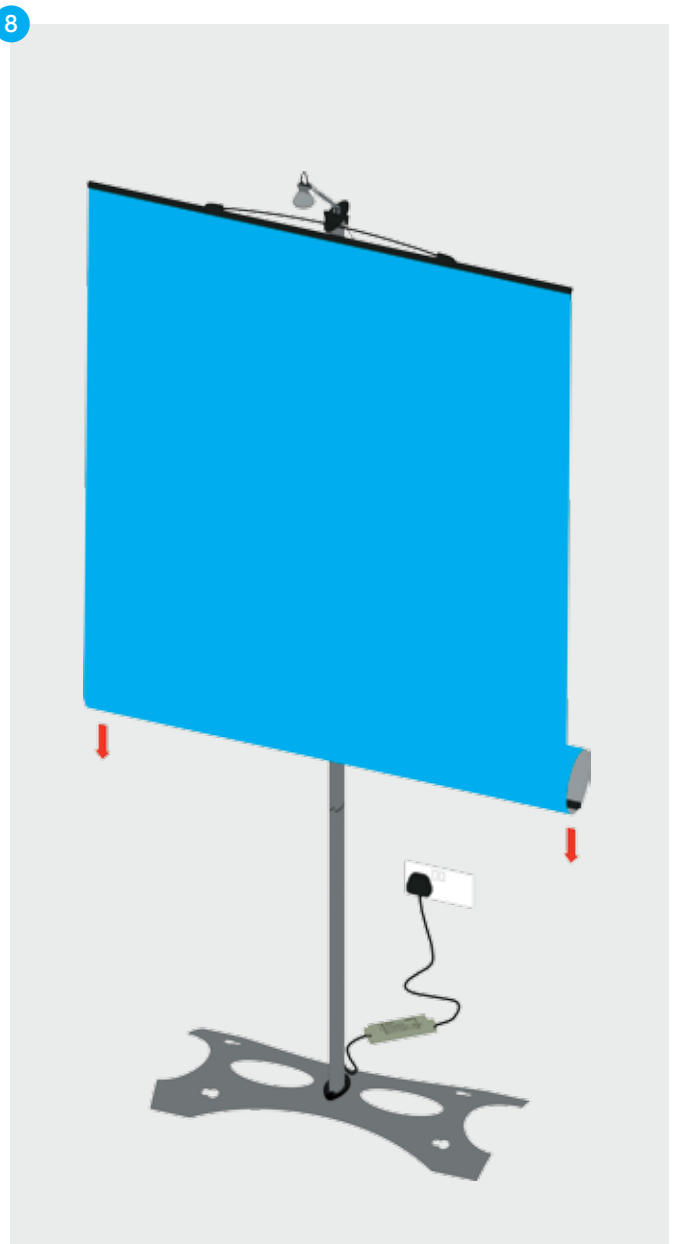
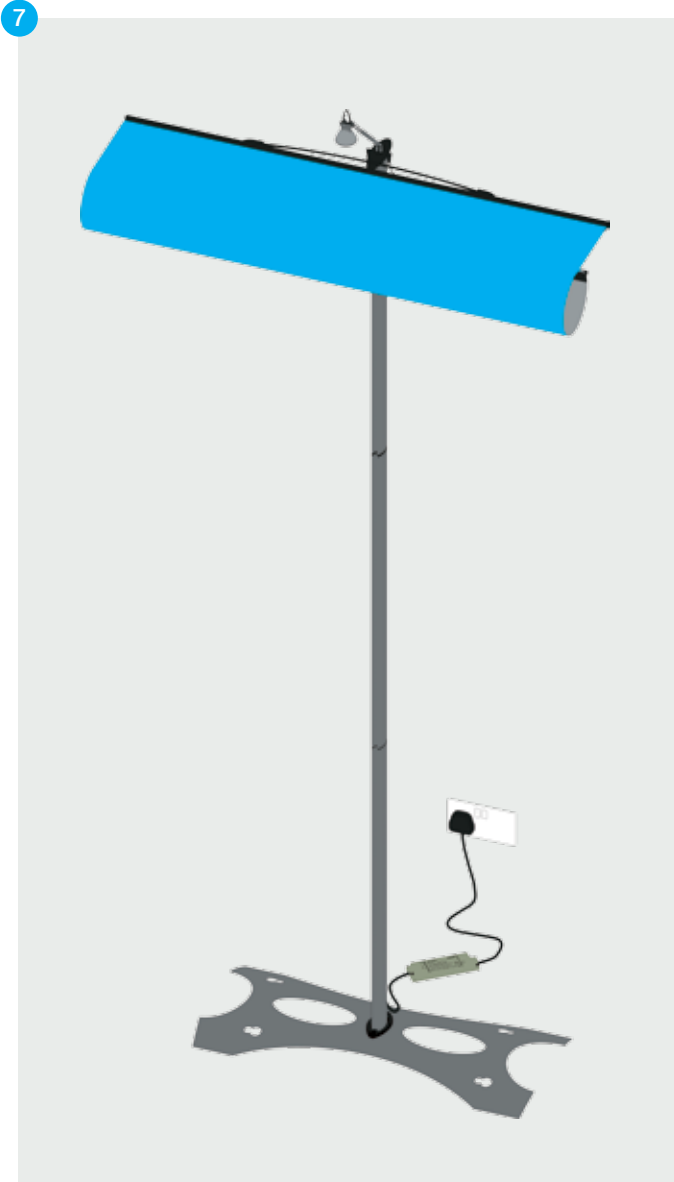

Twist Easi-link Setup Instructions

Items

2x linking pins, 3x magnetic bars, complete Twist stands.

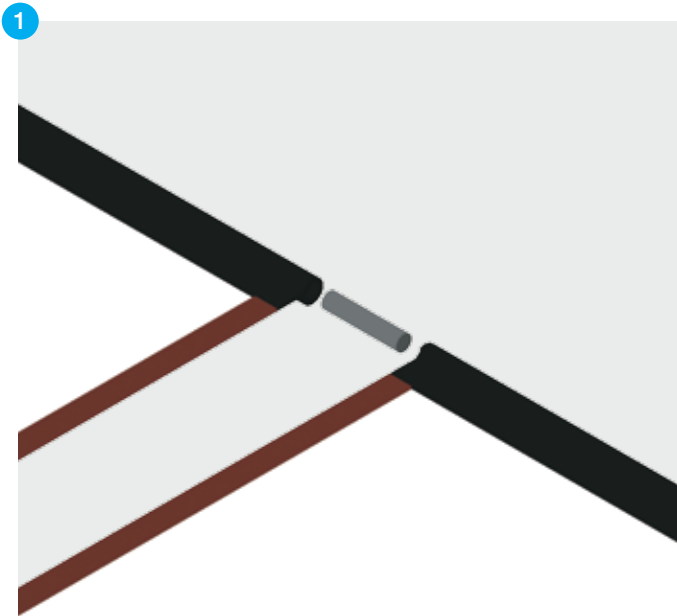

Place assembled Twist stands next to each other.

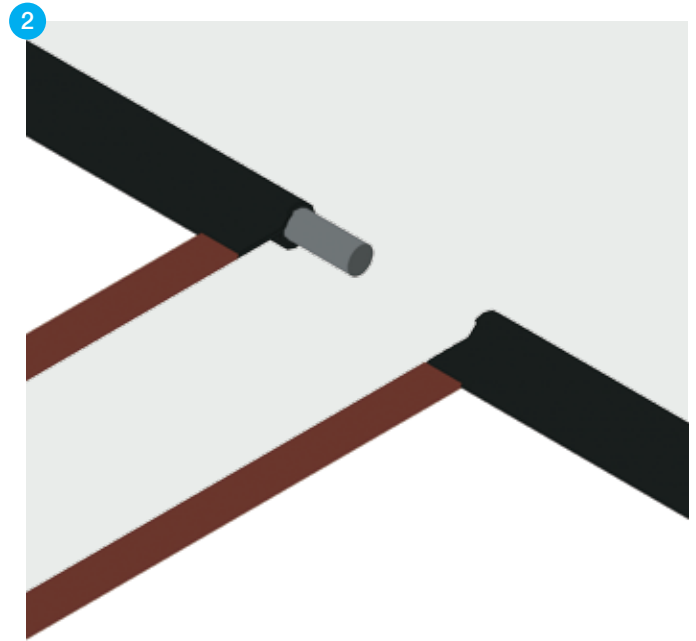

Place linking pins in top and bottom finishing strips.

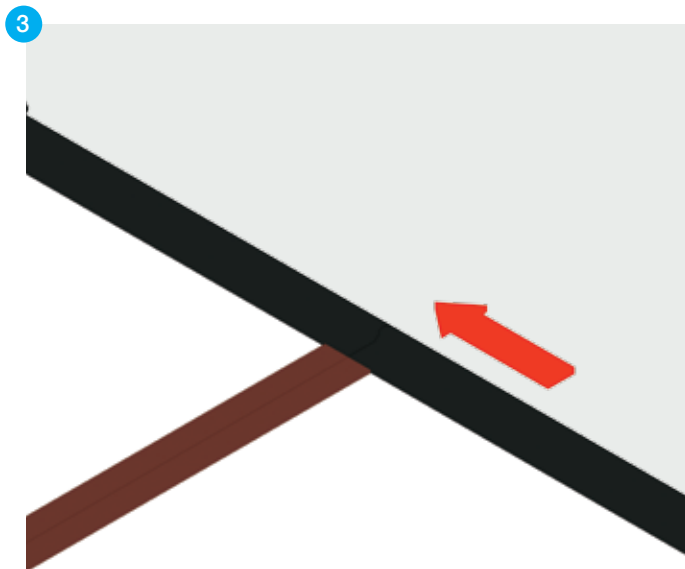

Link the two together and apply magnetic bars to magnetic tape on reverse of graphic panel.

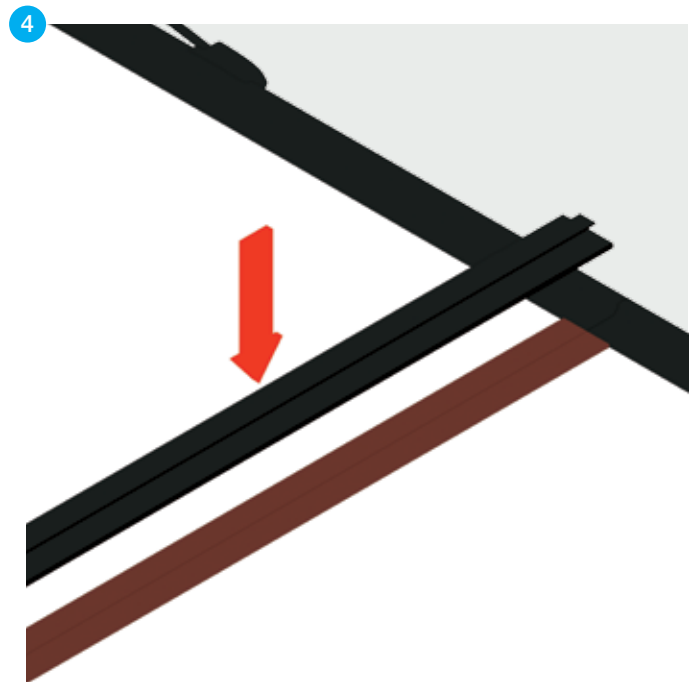

If graphic requires aligning, stand in front of Twist stands and place your finger at the bottom of the panel at the join, lift the lower graphic upwards to align graphics taking any slack to the top.

