

Twist®

TWIST FLEX-LINK

product set up instructions

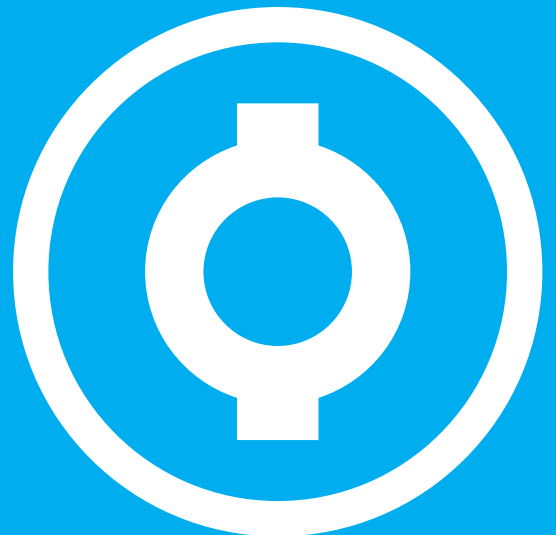

Twist Original Setup Instructions

Items

1x base with rubber grommet; 1x bottom upright section; 1x middle upright section; 1x top upright section; 1x light; 1x transformer; 1x graphic panel with finishing strips.

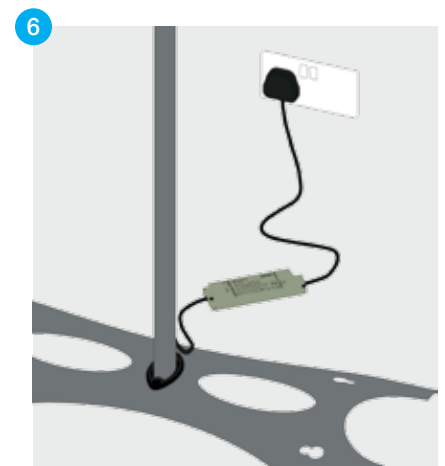
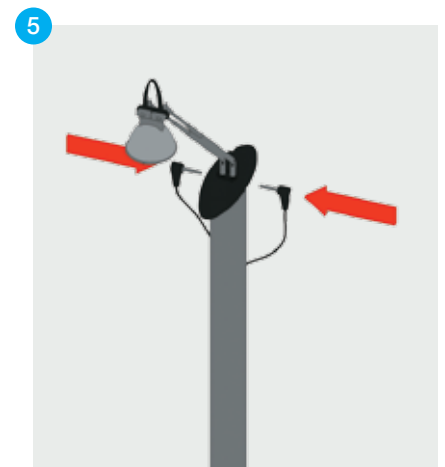
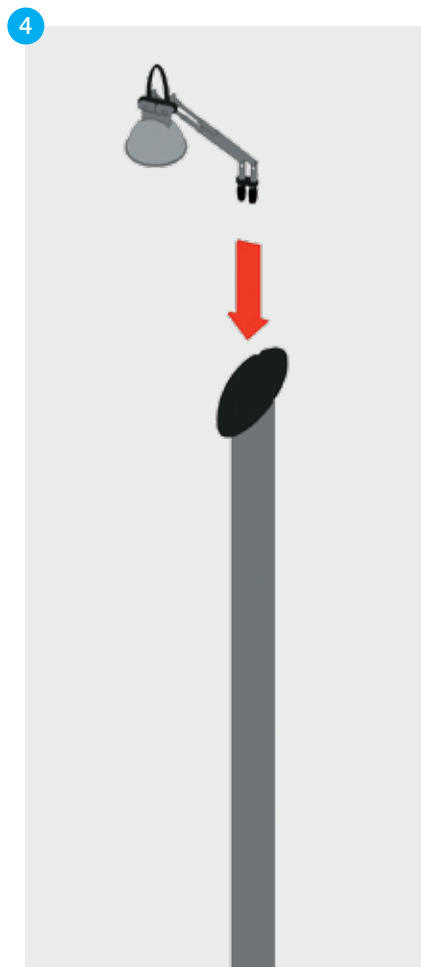
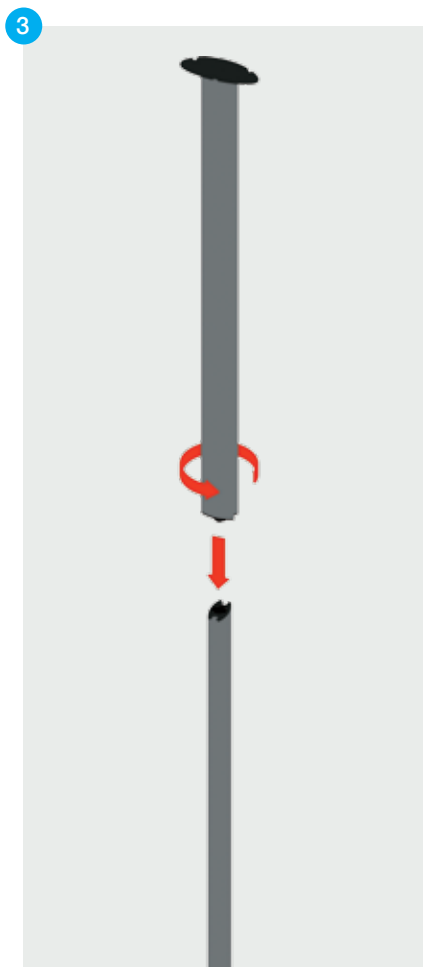
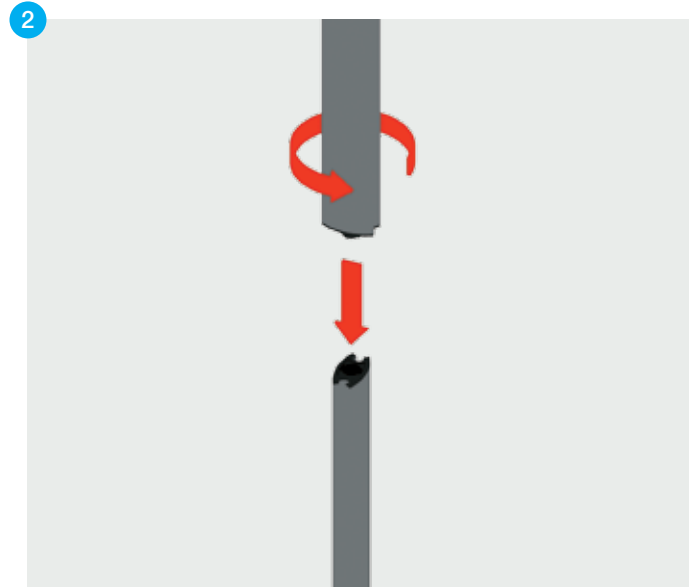
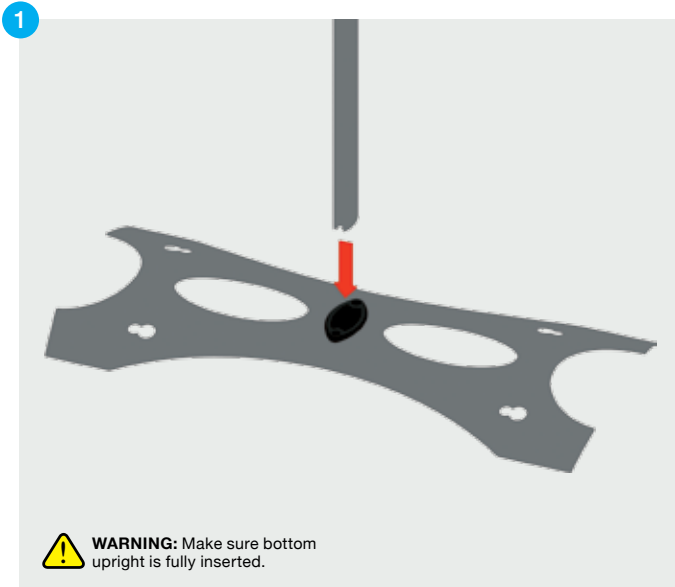

 **WARNING:** Make sure bottom upright is fully inserted. Twist the upright sections clockwise to lock, anti-clockwise to open – do not force.

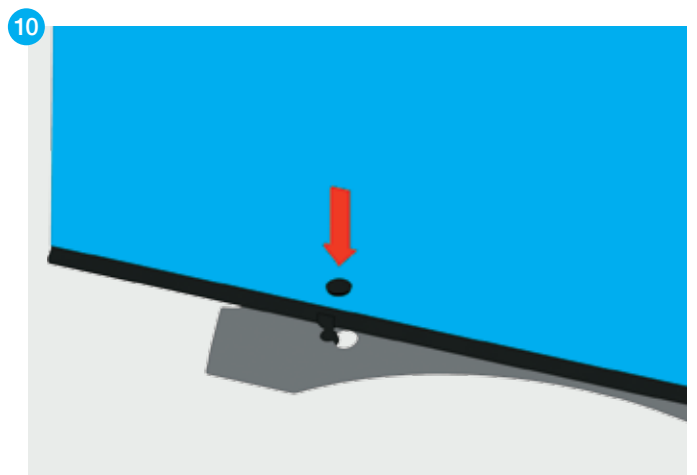
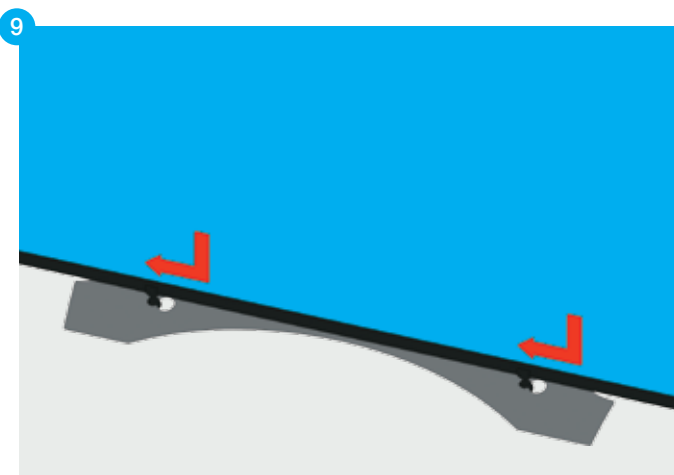
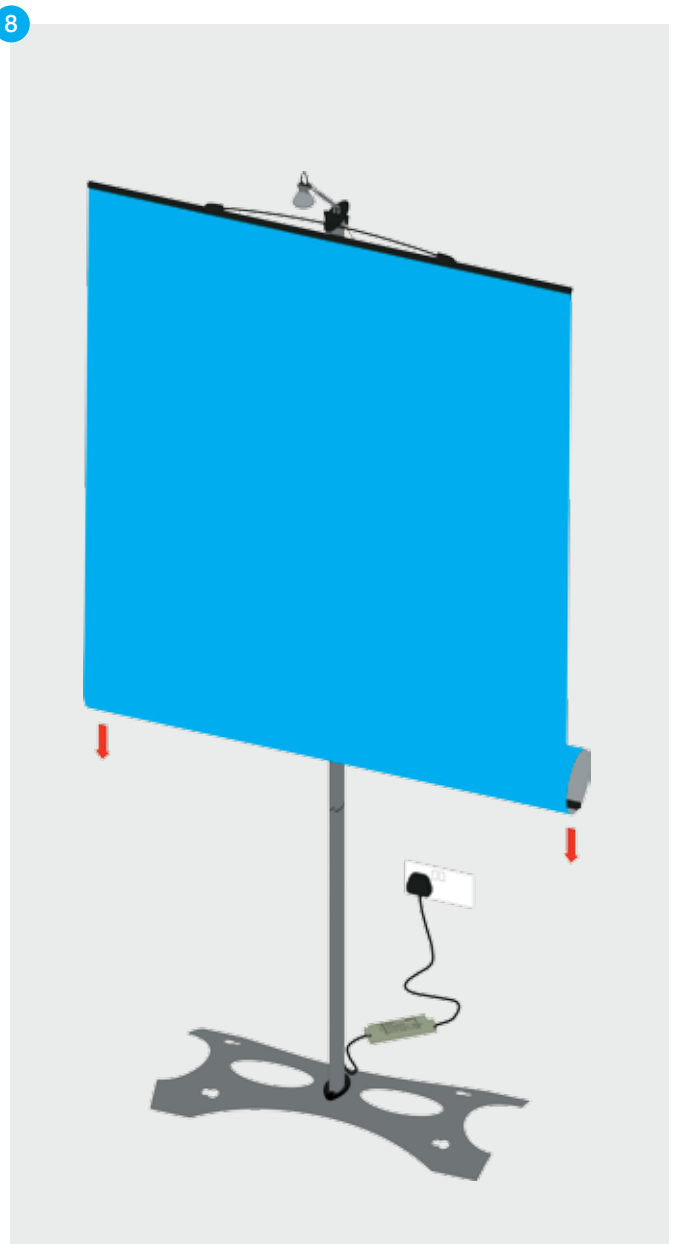
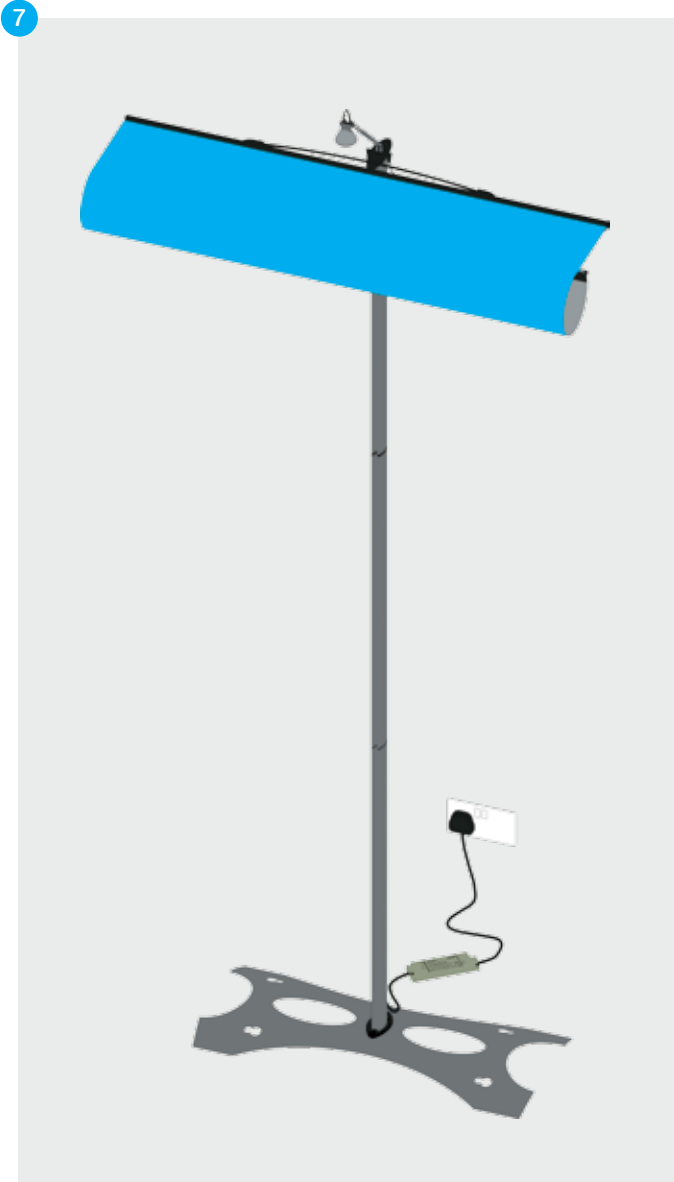

Twist Flexi-link Setup Instructions

Items

6x magnetic bars; 2x flexilink graphic panel; 2x complete Twist stands.

